



INSTALLATION INSTRUCTIONS

Product: Adjustable Rear Bump Stop System
Part Number: JKS1149

Applications: Wrangler JL, 2018-2021 (Rear only)

517-278-1226 • tech@jksmfg.com • www.jksmfg.com
491 W. Garfield Avenue, Coldwater, MI 49036

Welcome

CONGRATULATIONS on purchasing a set of new Adjustable BumpStops™ from JKS Manufacturing. We are committed to providing you with the best products available and your satisfaction is our first priority.

PLEASE READ these Installation Instructions carefully, and save them for future reference, as they contain important installation and maintenance information.

Important

MAY BE INSTALLED IN FIVE (5) POSSIBLE CONFIGURATIONS depending on individual spacer(s) used. Use appropriate hardware for your configuration. Refer to page 2 for details.

Tools Required

- Metric/Standard Socket Wrench Set
- Torque Wrench

** Asterisk denotes tools that are not required for some applications. Thoroughly read instructions first to determine which tools will be required for your application.*

Parts



	Description	QTY
A	2.00" BumpStop Spacer	2
B	0.50" BumpStop Spacer	8
C	5/16" x 1-1/4" Bolt	2
D	5/16" x 1-3/4" Bolt	2
E	5/16" x 2-1/4" Bolt	2
F	5/16" x 2-3/4" Bolt	2
G	5/16" x 3-1/4" Bolt	2
H	5/16" Serrated Flange Lock Nut	2
I	5/16" SAE Washer	2

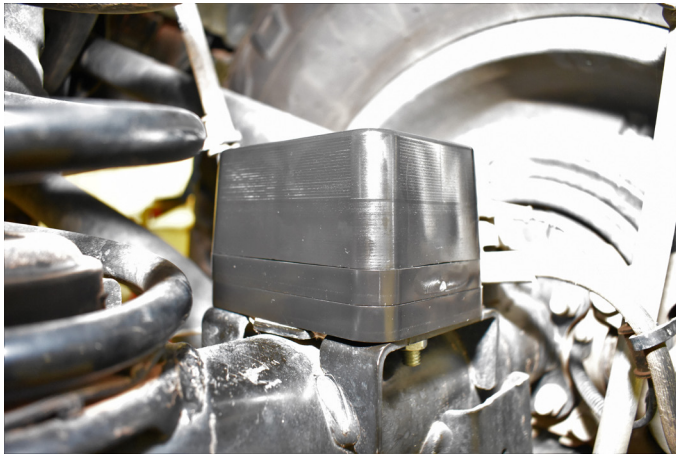

3" Bump Stop Configuration Pictured

3. INSTALLING BUMPSTOP SPACERS ON LOWER SPRING MOUNT

- Place selected bumpstop spacers on the factory bump stop pad on the axle, just outboard of the spring.
- Using the appropriate length hardware, attach the bump stop spacers to the axle.
- Torque bolts to 15 ft-lbs.

Installation

1. DETERMINE BUMPSTOP LENGTH

The JKS adjustable Front Bumpstop System can be installed in five unique configurations: 2", 2.5", 3", 3.5" and 4" depending on the number of 0.5" spacers used.

- Determine the ideal bump stop length for your application by considering factors such as:
 - Clearance between vehicle tires and body panels during full suspension compression
 - Clearance between axle housing and chassis or drivetrain during full suspension compression
 - Length of existing bump stop extension, if installed
 - Choose the spacer(s) that provides maximum, unobstructed suspension compression for your application from the list below.

<i>Bump Stop Length</i>	<i>Bolt Length</i>
2"	1-1/4"
2-1/2"	1-3/4"
3"	2-1/4"
3-1/2"	2-3/4"
4"	3-1/4"

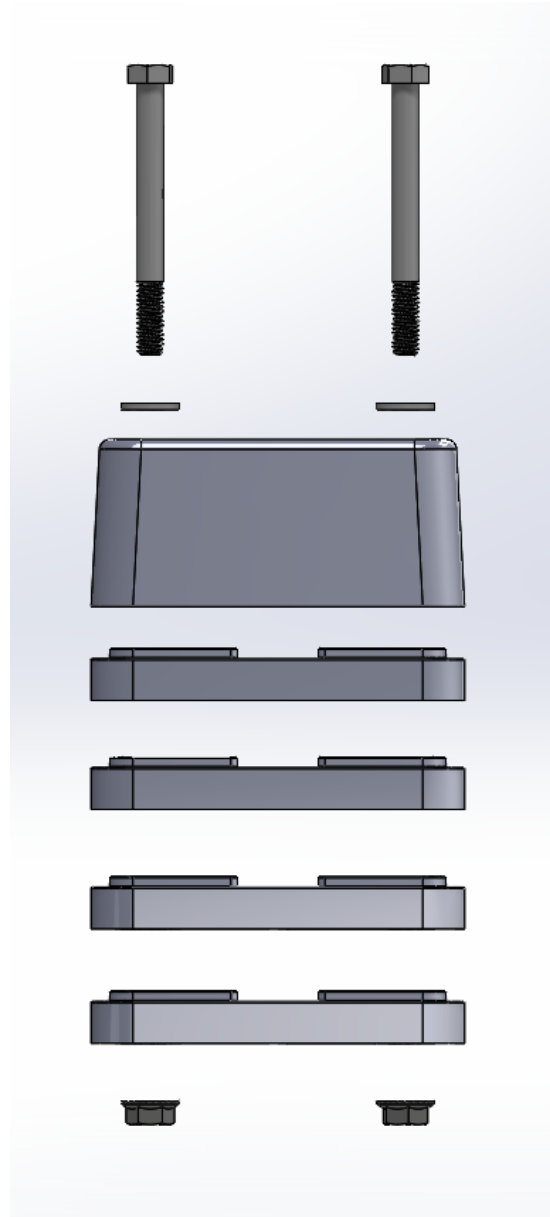

4" Bump Stop Configuration Shown

□ 4. **POST-INSTALLATION INSTRUCTIONS**

Before operating vehicle off-road, test for proper bump stop operation by fully cycling the suspension and checking for obstructions. Add, remove or replace BumpStop Spacers if necessary until maximum unobstructed suspension compression is achieved.

Maintenance

Regular cleaning with pressurized water is recommended to maximize ease of operation and reliability.

©2013 JKS Manufacturing, Inc & Aftermarketing, LLC
Revision Date 3/23/2021